

RoHS  
Compliant

### SPECIFICATION:

- Voltage rating:  
AC, DC, 30V(50HZ)
- Current rating:  
0.2A, DC(AWG#36)  
0.5A, DC(AWG#32)
- Withstand voltage:  
200V AC/minutes
- Working Temperature:  
-25°C~ +85°C
- Insulation resistance:  
≥500MΩ
- Contact resistance:  
≤0.02Ω
- Terminal mtr'l:  
Phosphor Bronze Tin Plated
- Material:  
Housing-PA9T,UL94V-0

	DIM.A	DIM.B	DIM.C	DIM.D	DIM.E
2	3.80	0.80	3.00	2.40	2.00
3	4.60	1.60	3.80	3.20	2.80
4	5.40	2.40	4.60	4.00	3.60
5	6.20	3.20	5.40	4.80	4.40
6	7.00	4.00	6.20	5.60	5.20
7	7.80	4.80	7.00	6.40	6.00
8	8.60	5.60	7.80	7.20	6.80
9	9.40	6.40	8.60	8.00	7.60
10	10.20	7.20	9.40	8.80	8.40
11	11.00	8.00	10.20	9.60	9.20
12	11.80	8.80	11.00	10.40	10.00
13	12.60	9.60	11.80	11.20	10.80
14	13.40	10.40	12.60	12.00	11.60
15	14.20	11.20	13.40	12.80	12.40
16	15.00	12.00	14.20	13.60	13.20
17	15.80	12.80	15.00	14.40	14.00
18	16.60	13.60	15.80	15.20	14.80
19	17.40	14.40	16.60	16.00	15.60
20	18.20	15.20	17.40	16.80	16.40
21	19.00	16.00	18.20	17.60	17.20
22	19.80	16.80	19.00	18.40	18.00
23	20.60	17.60	19.80	19.20	18.80
24	21.40	18.40	20.60	20.00	19.60
25	22.20	19.20	21.40	20.80	20.40
26	23.00	20.00	22.20	21.60	21.20
27	23.80	20.80	23.00	22.40	22.00
28	24.60	21.60	23.80	23.20	22.80
29	25.40	22.40	24.60	24.00	23.60
30	26.20	23.20	25.40	24.80	24.40

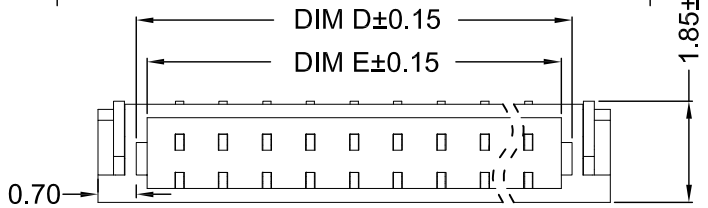
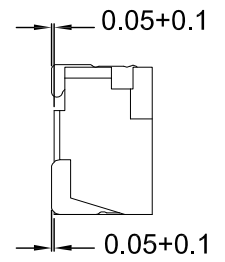
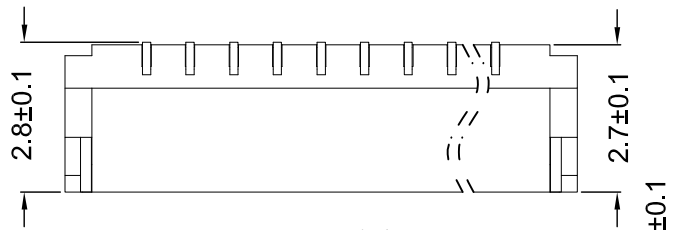

### Ordering Information

**WB** - **3** - **XX** - **PT** - **08WT** - **4** - **44**  
 0.8P Wafer    Solder/PCB    Total PIN    Contact Plated    Packing  
 1:DIP RA    2:DIP VT    3:SMT RA    4:SMT VT    PT: Tin    4:Tube

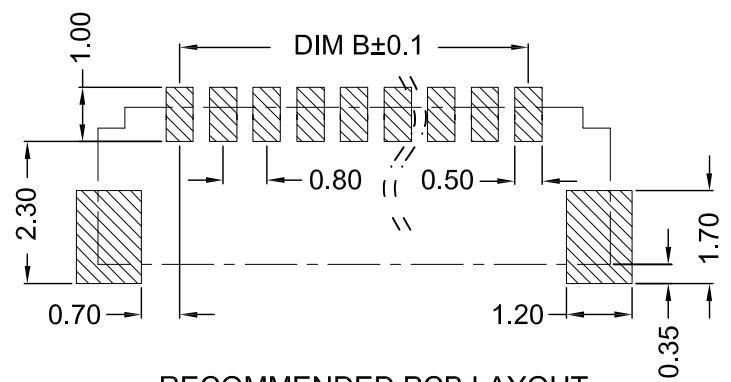

REV.	REVISION RECORD	DATE	General Tolerances		
A	Original	08/14/13'	LINEAR	0.0 ± 0.35 0.00 ± 0.20	ANGLES ± 3°
B	Revised P/N	01/16/15'	UNIT: mm		
C	Revised P/N	05/25/16'	A4	NAME	DATE
			APPROVED	WENDY	
			DESIGNER	WHITE	
			DRAWN	ANGEL	



TITLE: 0.8P Wafer SMT Right Angle 1.85H  
 DWG.NO.: WB3XXPT08WT4-44    REV. C  
 SCALE    1 : 1    SHEET    1 OF 1